

GREAT HALL GALLERY

FOUNDATION BUILDING

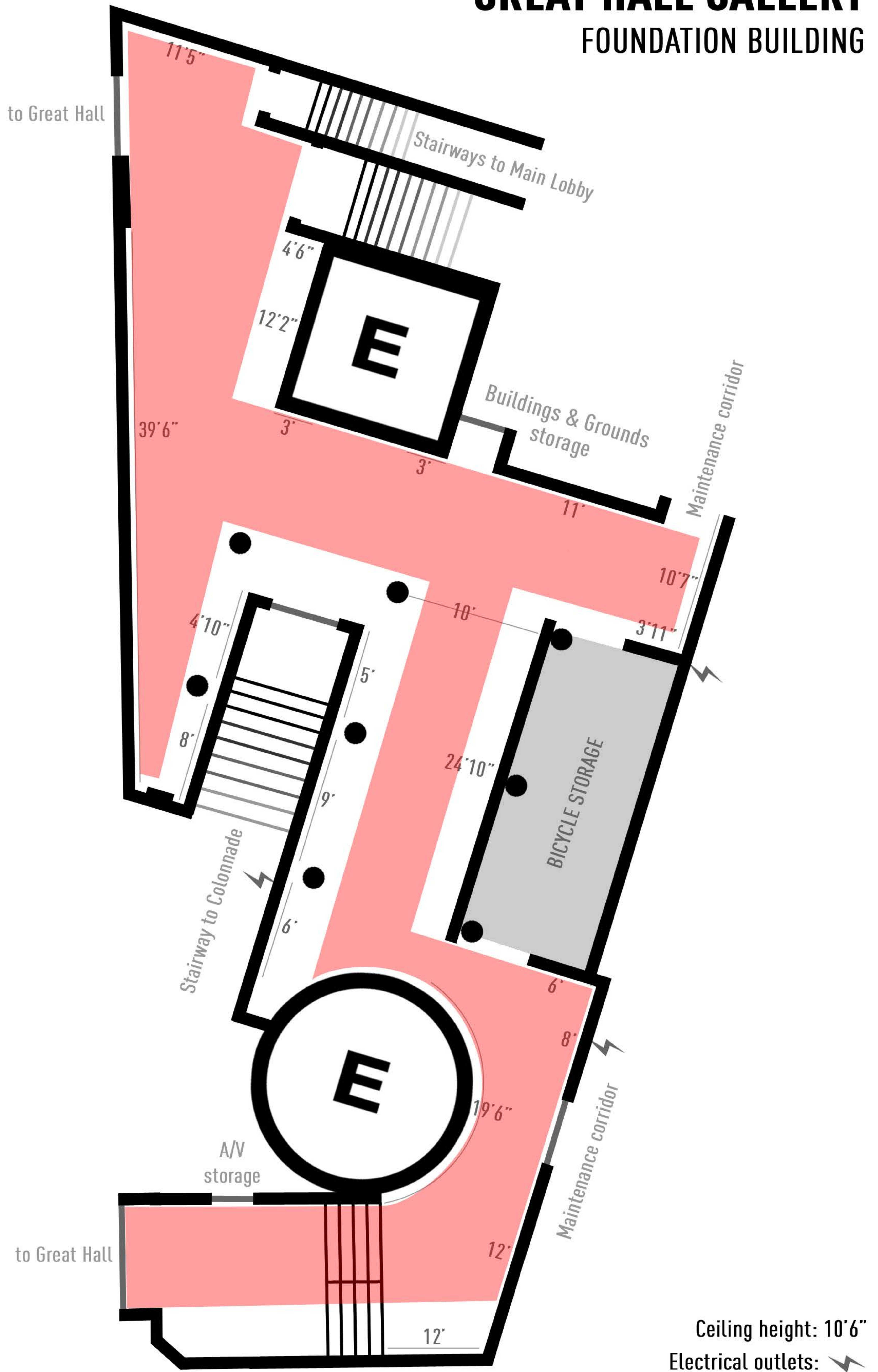

Areas marked in red should remain clear.

GREAT HALL GALLERY

FOUNDATION BUILDING

General Guidelines

- Wall structures/projection screens must be hung at least 18in below the ceiling.
- Large anchors or screws may not be used on the columns. Smaller hardware and alternative installation options are possible.
- No drilling or anchoring to the floor.
- Lights directly in front of the elevators and exit stairwells must remain illuminated. Exit signs and the fire hose cannot be obscured or covered.
- Floor work is **not allowed**. Exceptions may be made on a case by case basis with prior approval from the Art Office.
- A clear line of sight and direct path must be maintained from any elevator or office to the exit stairs.
- Do not block or obstruct office/maintenance doors.
- Because of the close proximity to The Great Hall auditorium, audio components may **only** be used with headphones. All other audio components for the exhibition and reception are **not allowed**. Exceptions may be made on a case by case basis depending on the Great Hall Auditorium programming and with prior approval from the Art Office.